



THE WIMBLEDON CLUB

Prospectus





WELCOME TO THE WIMBLEDON CLUB

Owned by its members The Wimbledon Club is Wimbledon's Premier multisport club with fitness suite and separate sections for Tennis, Squash, Cricket and Hockey.

| 3

Situated opposite the world-famous All England Lawn Tennis Club, The Wimbledon Club offers a friendly atmosphere in a beautiful environment with some of the finest sports facilities in London.

The famous spire of St. Mary's Church overlooks the club's nine acre grounds and modern clubhouse, which is surrounded by Wimbledon Park Golf Club on three sides and by Wimbledon Park Lake on the fourth.

The first floor bar and restaurant with surrounding terrace overlooks the tennis courts, cricket field and lake, providing the perfect location to relax and spend time with family and friends.



ABOUT THE CLUB

HISTORY

The Wimbledon Club was founded on its present site in 1890 when Wimbledon Cricket Club (founded in 1854 on Wimbledon Common) joined with a new Tennis section. Wimbledon Hockey Club and Wimbledon Ladies Hockey Club hired the ground in winter and were incorporated into the Club in the 1970s. The first squash court was added in the 1930s and Wimbledon Lakeside Squash Club was formed in 1973.

SPORTING FACILITIES

SQUASH

Voted London Club of the Year, TWC Squash is one of very few clubs nationally to hold Gold Status for the England Squash Club Mark, the highest accolade a club can be awarded by its governing body. In 2021 all five courts (four glass-backed) were fully renovated leaving all courts in pristine condition. An annual refurbishment programme ensures the courts remain in first class condition.

HOCKEY

The club has numerous hockey pitches at Kings College School and Ricard's Lodge High School plus a world class, water-based Astro pitch at Raynes Park High School.

CRICKET

Wimbledon Cricket Club is widely regarded as having one of the highest quality outfield & pitches in Surrey. Two new hybrid pitches were sewn in 2020 with plans to add a further three in 2022. Our four lane outdoor net facility was re-laid during 2021 and our members have access to indoor nets within our sports hall during the winter months.

TENNIS

New LED lighting was installed on all 15 tennis courts in 2021. Three of the seven artificial clay courts are housed indoors under a bubble during the winter months, two courts are acrylic and six are grass.



A FULLY INCLUSIVE, MODERN CLUB

The Club is dedicated to providing safe, fair and inclusive sporting environments and is open to everyone regardless of age, gender, disability, cultural background or sexual orientation. Good governance, integrity, equality, member protection and child safeguarding are the core values that steer each of TWC's sporting sections. Our staff, coaches and volunteers make people from all backgrounds, ages and abilities welcome, respected and to feel that they belong at The Wimbledon Club.

FAMILIES AND JUNIORS

The 3,500 strong membership is comprised of a near equal split of adult to junior members across the four sports and fitness suite making TWC a popular, family orientated club. Juniors can begin their sporting pathway from two years of age via the Short Sports Programme. Classes enhance the hand-eye coordination and motor skills of young children preparing them for later sporting success.

| 7

SCHOOLS

The Club recognises its responsibility to the local community, welcoming numerous independent and state schools equally to use its different sporting facilities each week.

CARING FOR THE COMMUNITY

Beyond the active schools programme TWC is proud to have pioneered the UK's first Squash and Education Programme for disadvantaged children. The Squash Squared initiative ensures children from all backgrounds, regardless of family financial circumstances can become members of the club.

The charity plays a vital role in making sure squash reaches the masses at grass roots level and provides an opportunity for pupils to play and study in safe surroundings. The Wimbledon Club is the first club in the United Kingdom to found, support and run such a scheme.



SPORTING ACHIEVEMENTS & TEAMS

SQUASH

Every year The Wimbledon Club organises and hosts one of the UK's largest professional, world ranking tournaments on the PSA World Tour attracting worldwide coverage.

In 2019 world number 3 Marwan Elshorbagy won the \$50,000 prize fund and a \$10,000 ladies event was introduced for the first time in 2021. Our PSA event in 2022 featured six of the world's top ten players.

It was played on a glass court to a full capacity crowd and was won by world number one Ali Farag.

TWC's junior squash programme is one of largest in the UK. Enthused by campaigns such as "This Girl Can" the club actively encourages girls into the sport and has a flourishing squad of female players. The Surrey county squad is populated with more junior players from TWC than any other surrey Club.

Fourteen teams from junior to vintage age groups play singles and doubles fixtures across numerous London and Surrey leagues including the prestigious Bath Cup, normally the preserve of central London Clubs. Both ladies' and men's first teams play in the highest division of Surrey Cup, one of the strongest leagues in the UK where players ranked inside the world's top ten regularly compete.

TWC's Ladies teams have won the top division twice.

CRICKET

The Wimbledon Cricket Club is one of the most popular and successful clubs in the Surrey Championship, National Cup and National T20 competitions.

Comprised of over 1,000 members across five Adult XIs in the Surrey Championship Premiership, our newly formed Women's League XI, three Academy (U17 – U21) XIs and 34 Surrey Junior Championship Teams, the Wimbledon Club is one of the biggest and most professionally run amateur Clubs in the country.



TENNIS

The Tennis section operates at full capacity with 882 adult and 270 junior tennis members. 12 adult teams (5 men and 7 ladies) and 8 junior teams compete regularly in county, regional and national competitions whilst the top men's and ladies' teams compete in the national division.

An extensive adult tennis programme incorporates all abilities, from social tennis to team training sessions throughout the week, including Coffee Mornings and Cardio Tennis. Competitions are organised throughout the year and culminate in our annual Tennis Club Championships every Summer.

An after-school junior coaching programme has sessions for beginners through to team standard and tennis camps run during every school holiday. Internal competitions introduce children to competitive tennis and those of an appropriate standard are encouraged to compete externally and to represent the club in our junior league teams.

HOCKEY

With 850 Juniors and 300 senior members, The Wimbledon Hockey Club is one of the largest clubs in Europe and has a successful track record in competition. Both the men's and ladies' first teams compete in the Premier League and no fewer than ten Wimbledon team players have represented Great Britain.

Historically strong, the club's rise to becoming one of the UK's strongest teams began in 2008 by winning the Hampshire/Surrey regional league. A run of 4 promotions in 6 seasons followed and in 2013 the club made its debut in the Premier League.

The following two seasons culminated in Wimbledon being crowned Premier League Playoff champions which permitted the club to play in the Euro Hockey League in 2016 in Amsterdam. A year later

TWC Hockey was one of the top four teams in the European Hockey League. This was the first time in almost a decade since an English club last reached this stage.



SPONSORSHIP OPPORTUNITIES

The Wimbledon Club seeks to create long-lasting, mutually beneficial relationships with partners who share our passion for sport at every level from grass roots through to elite level.

The Wimbledon Club can offer fresh marketing ideas to prospective partners. Our Sports Directors will work collaboratively to devise an appropriate sponsorship strategy and a tailored business plan to optimise a company's brand awareness.

From on-shirt sponsorship and social media campaigns to engaging VIP sporting experiences for company staff, TWC is capable of providing multiple marketing outlets for any business.

For an innovative and creative plan of action to raise your company's profile in partnership with The Wimbledon Club please contact reception@twcsport.co.uk or the respective Director of Sport.

| 13





DINING, BAR & RESTAURANT

TWC BAR

The Bar is on the first floor of the clubhouse and has sweeping views over the tennis courts, cricket pitch and lake. There is plenty of space for members and guests to eat, drink and relax.

Enjoy watching a match over a beer in The Bar; join the family for Sunday lunch or take in the evening sun with a chilled glass of white wine on our terrace.

The Bar is also open during the day and has complimentary wi-fi making for a good place to catch up with friends or open up the laptop.

| 15

THE LAKESIDE CAFÉ

The Lakeside Café is open seven days a week and offers an all-day menu in a friendly and welcoming environment. With an outdoor terrace it is the perfect spot for summer al fresco dining.

TWC RESTAURANT

Our restaurant offers a popular Sunday lunch and a varied menu designed to offer flexibility with healthy options, comfort food and hearty dishes for refuelling after your sporting exertions.



ROOM HIRE & EVENTS

The Wimbledon Club is a flexible venue that can accommodate up to 138 guests in varying locations. Our large open-plan Lake Room, Bar, patio and terrace all have stunning views over the Club's grounds and can be decorated to your requirements. It is a superb venue to host anything from a ball or fundraiser or to simply celebrate with family and friends.

CATERING & DRINKS

The Wimbledon Club offers a range of catering options. Whether it is a buffet or a formal dinner our Head Chef will be happy to plan a menu to suit your guests and budget.

Hiring a room can be fully staffed and with a stocked bar or simply an open space. A good selection of beers, wines and spirits are available.

| 17

The Wimbledon Club staff will be very happy to discuss any special requests you may have for your event.

MUSIC

TWC is licenced for live music, should you wish to hire a band. We also have a DJ that we can recommend. If you would like to provide your own music we can provide the equipment for you to simply plug in your iPod.

CONFERENCES & BUSINESS MEETINGS

We have two, well-appointed meeting rooms that can cater for up to 110 people. All rooms have plenty of natural daylight and AV projection facilities.



ROOM CAPACITY & CONFIGURATIONS



Stand up
reception



Boardroom



Theatre



Dinner



Dinner/dance

| Room name | Stand up reception | Boardroom | Theatre | Dinner | Dinner/dance |
|---------------------|-----------------------|-----------|---------|-------------|--------------|
| Lake Room | 110 | 70 | 110 | 80 | 60 |
| Garden Room | 75 | 40 | 50 | buffet only | - |
| Restaurant | 48 | 36 | 48 | 48 | - |
| Lounge | 90 | 50 | 90 | 80 | 60 |
| Lounge & Restaurant | 138 | - | - | 110 | 100 |

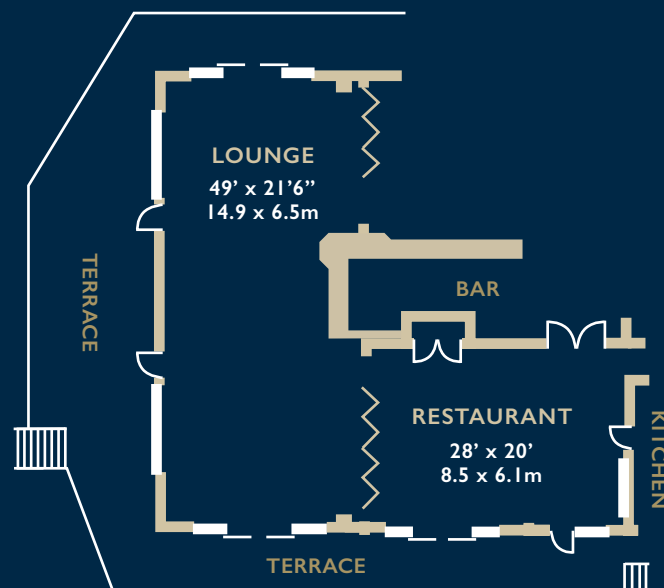

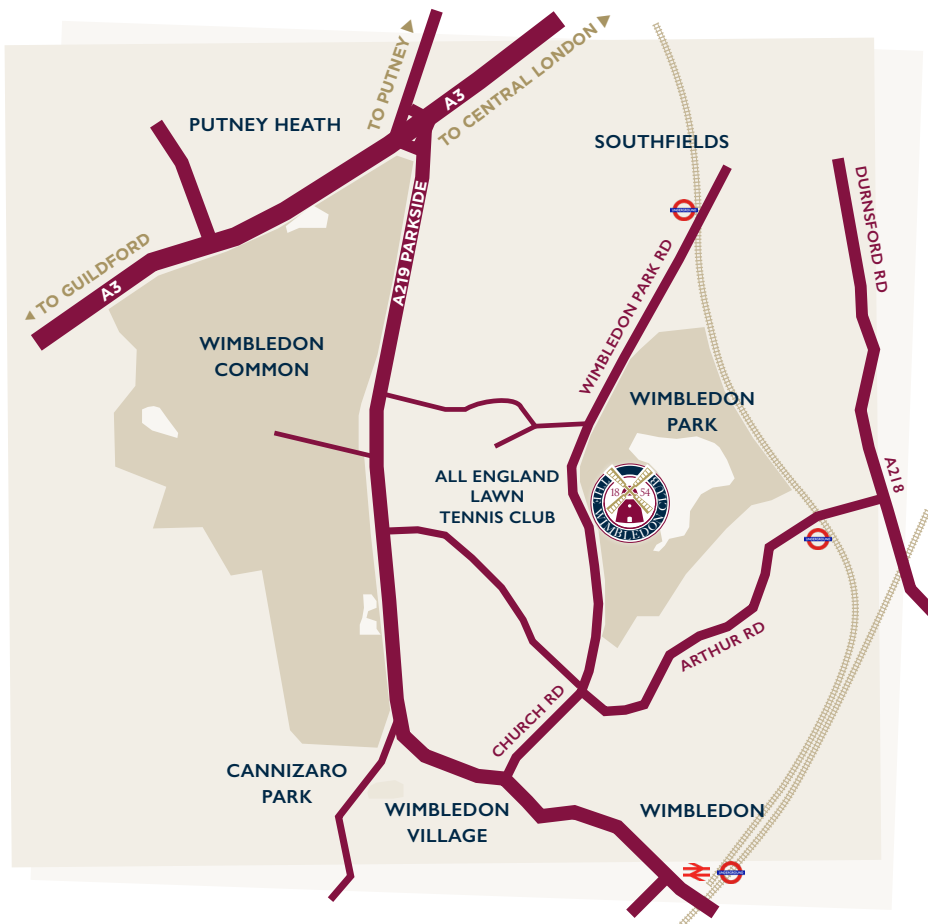

SPORTS DIRECTORS:

SQUASH DIRECTOR

Stacey Ross

director@twcsquash.co.uk

CRICKET DIRECTOR

Jonathan Speller

director@twccricket.co.uk

HOCKEY

director@twchockey.co.uk

TENNIS DIRECTOR

Ross Sheppard

director@twctennis.co.uk

CONTACT US TODAY

For general enquiries please contact our reception:

reception@twcsport.co.uk

020 8971 8090

For more information and to discuss the available opportunities, please do not hesitate to get in touch with our sport directors.



THE WIMBLEDON CLUB
CHURCH ROAD
WIMBLEDON
LONDON SW19 5AG

020 8971 8090

INFO@TWCSPORT.CO.UK

WWW.TWCSPORT.CO.UK

VAT No: 216 3113 10

   @TWCsport